

Installation wall behind pond

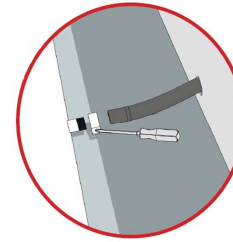

9

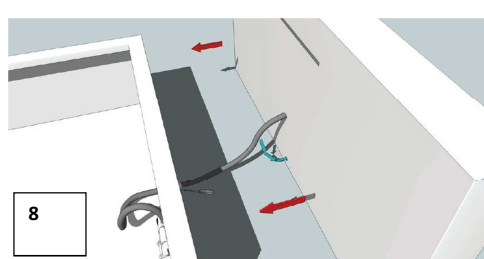
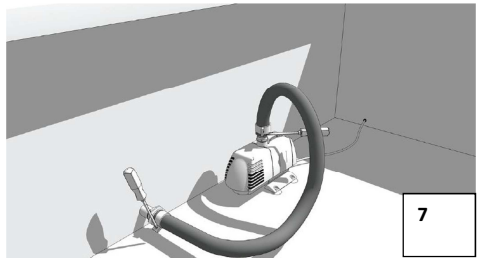
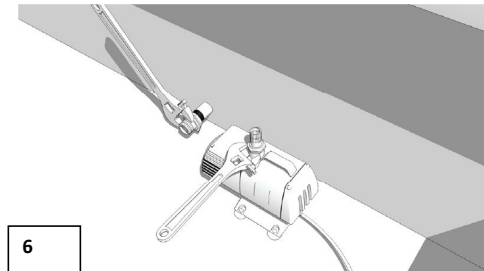
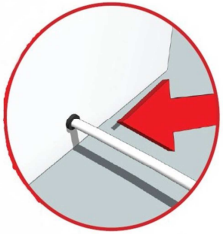
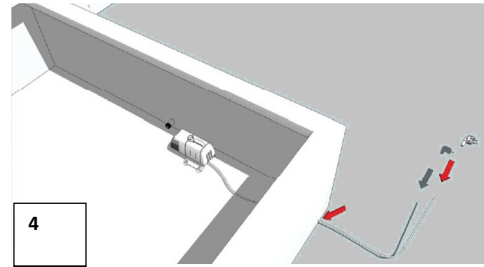
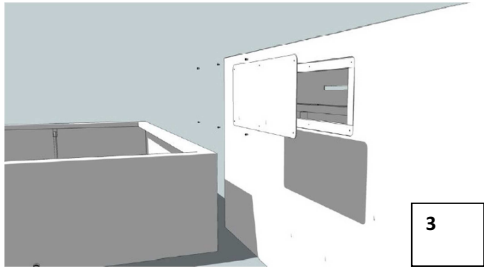
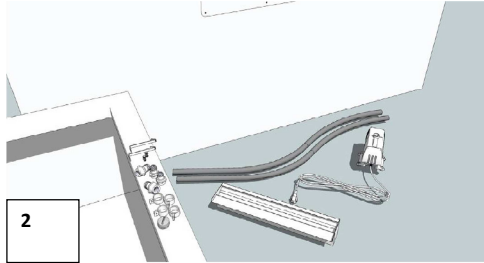
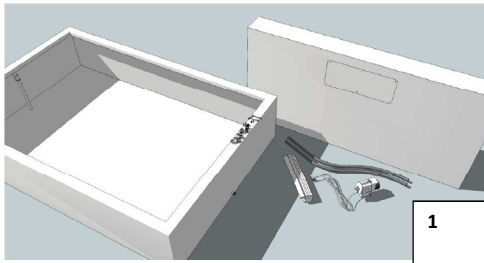
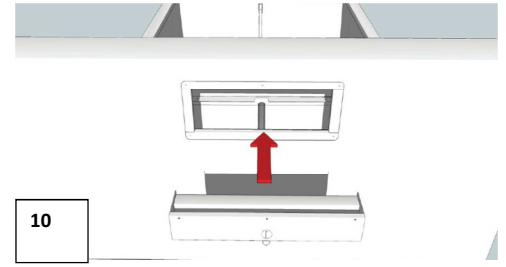

10

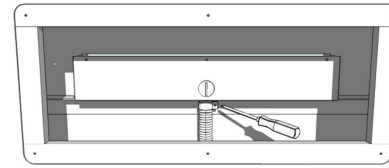

11

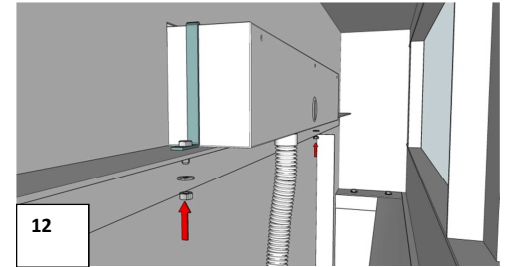

12

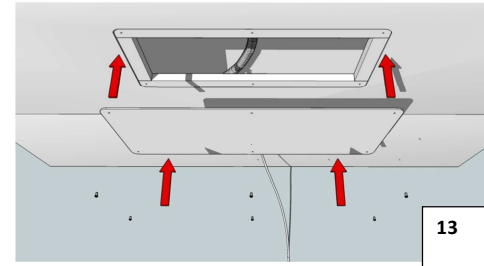

13

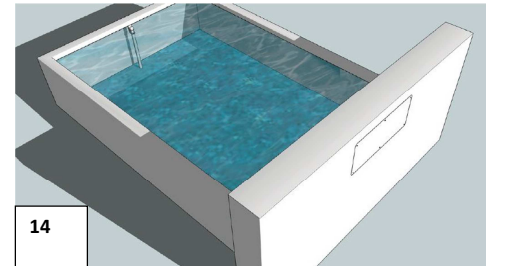

14

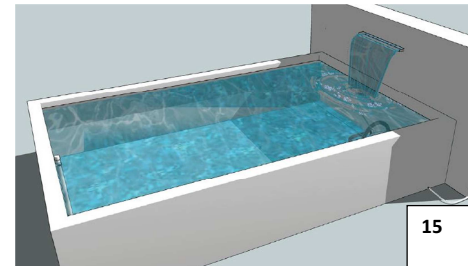

15

Waterfall 1500, wall BEHIND pond

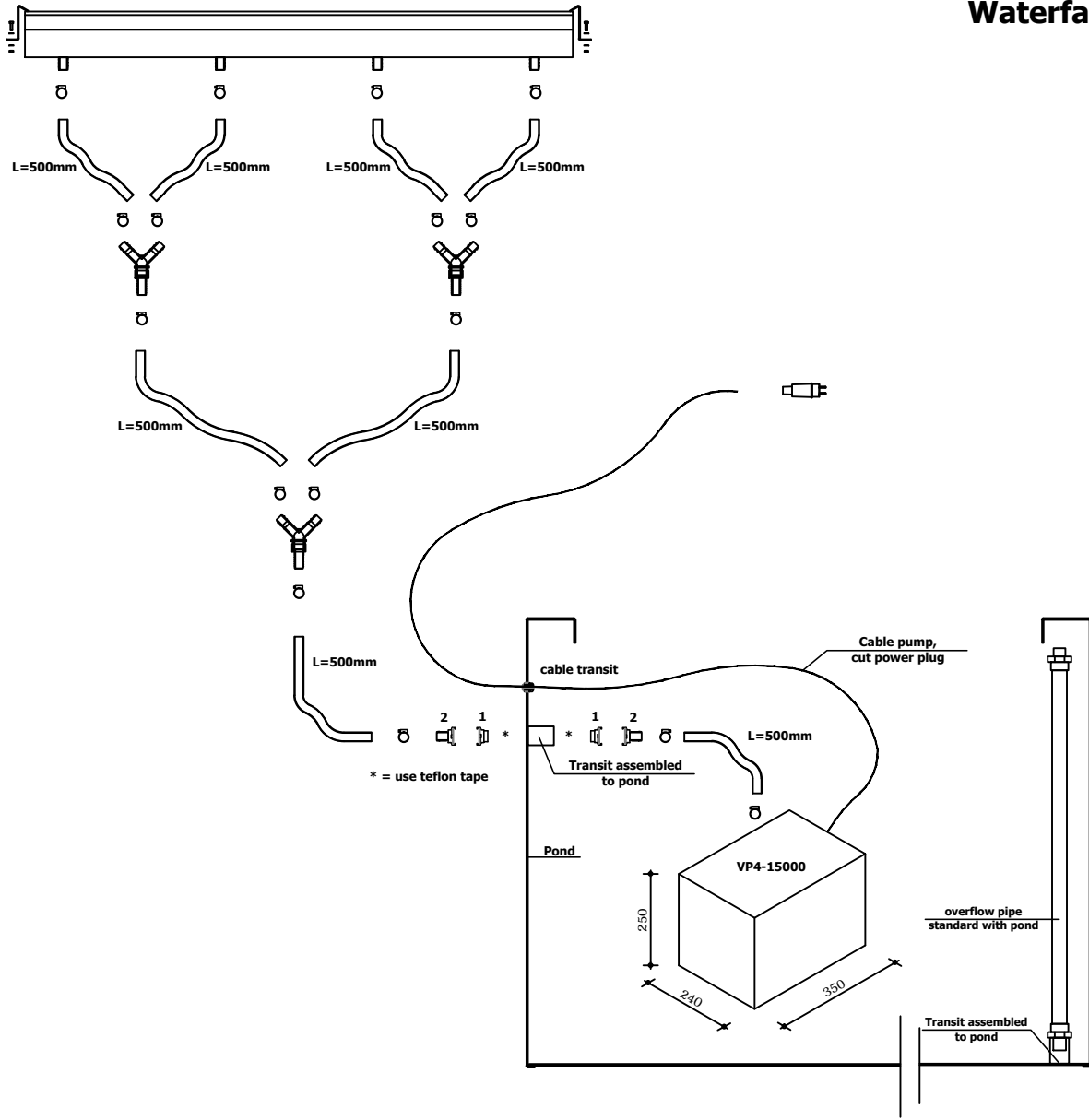

Number	Description	Code
1	Waterfall 1500-50	VB3
1	Waterfall 1500-150	VB4
1	Pump 15000	VP4
2	Hook for fixation (Z-profile)	-
2	Bolt M6-20	-
2	Nut M6	-
4	M6-ring	-
16	Hose clamps	-
3	Y-pieces	-
1	Hose 8x 0,5m	-
1	Cable transit	-
1	Power plug	-
2	GeKa hose tail 1 (3/4" outer thread)	-
2	GeKa hose tail 2 (with hosetulle)	-
1	Teflon tape	-

Waterfall 600, wall BEHIND pond

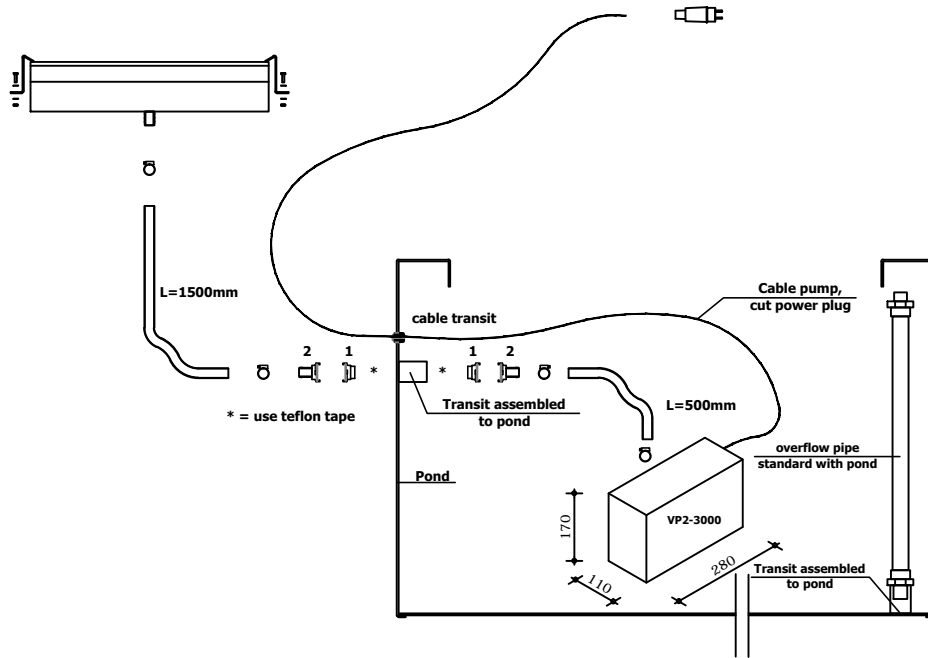

Number	Description	Code
1	Waterfall 600-50	VB1
1	Waterfall 600-150	VB2
1	Pump 3000	VP2
2	Hook for fixation (Z-profile)	-
2	Bolt M6-20	-
2	Nut M6	-
4	M6-ring	-
4	Hose clamps	-
1	Hose 2,0m (1x0,5 + 1x1,5m)	-
1	Cable transit	-
1	Power plug	-
2	GeKa hose tail 1 ($\frac{3}{4}$ " outer thread)	-
2	GeKa hose tail 2 (with hosetulle)	-
1	Teflon tape	-

3 tubes waterfall, wall BEHIND pond

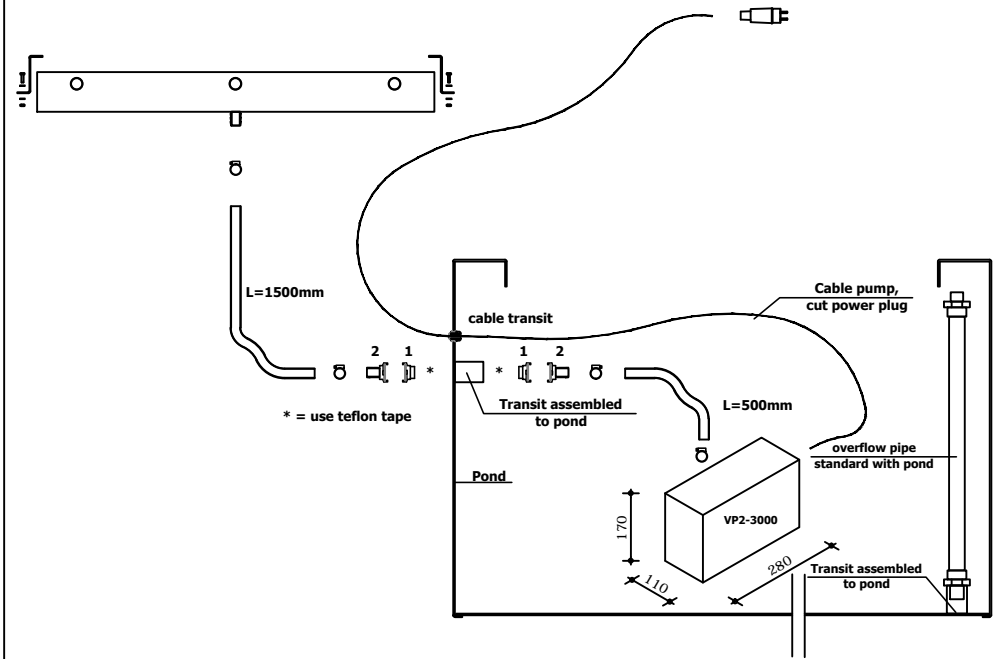

Number	Description	Code
1	Waterfall 3 tubes	VB5
1	Pump 3000	VP2
2	Hook for fixation (Z-profile)	-
2	Bolt M6-20	-
2	Nut M6	-
4	M6-ring	-
4	Hose clamps	-
1	Hose 2,0m (1x0,5 + 1x1,5m)	-
1	Cable transit	-
1	Power plug	-
2	GeKa hose tail 1 ($\frac{3}{4}$ " outer thread)	-
2	GeKa hose tail 2 (with hosetulle)	-
1	Teflon tape	-

Installation Wall directly on pond

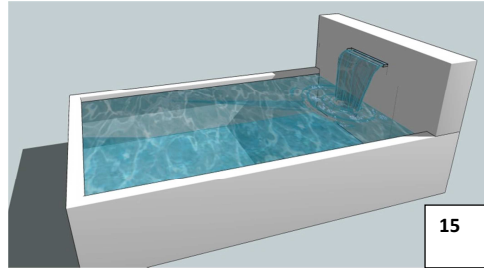
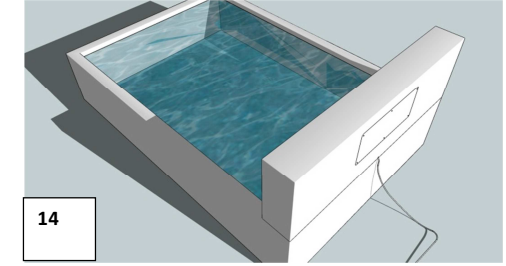
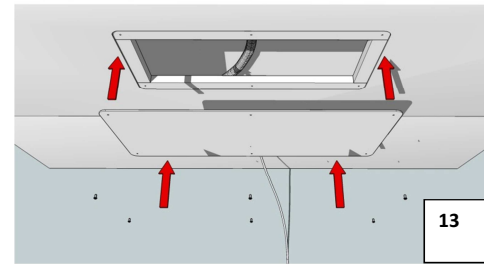
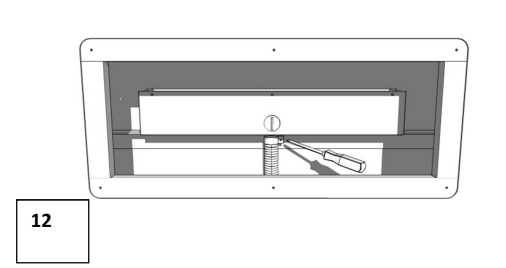
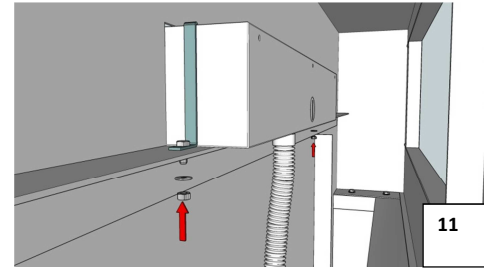
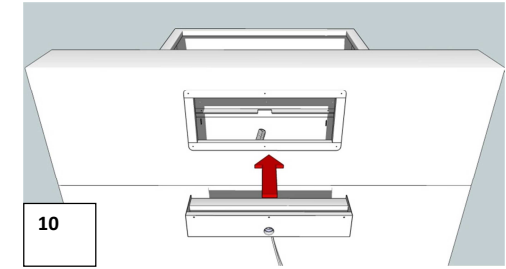
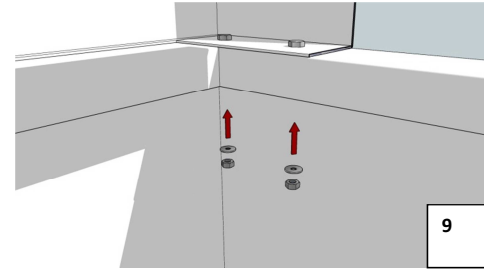
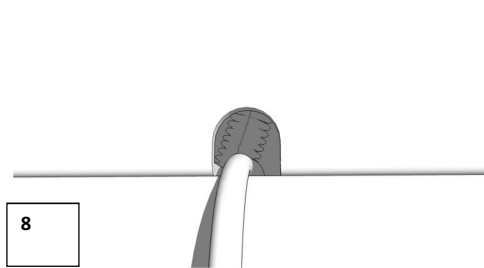
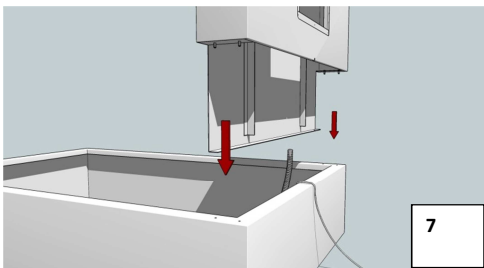
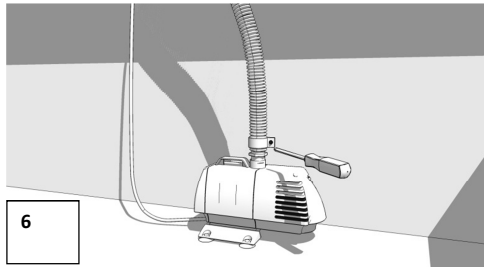
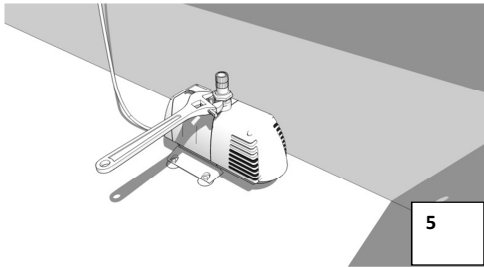
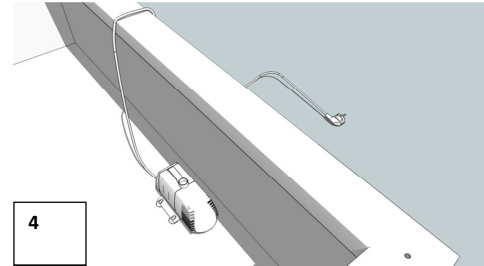
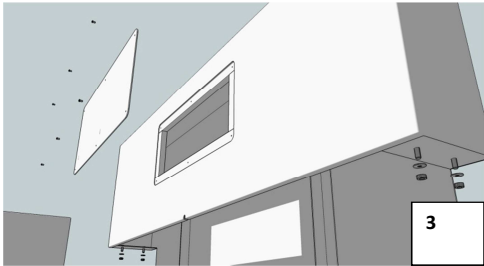
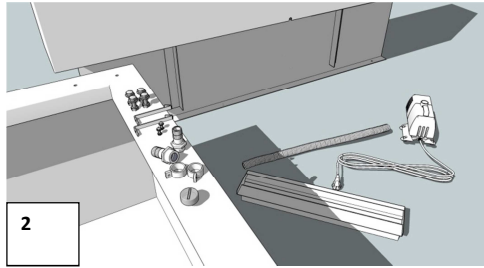
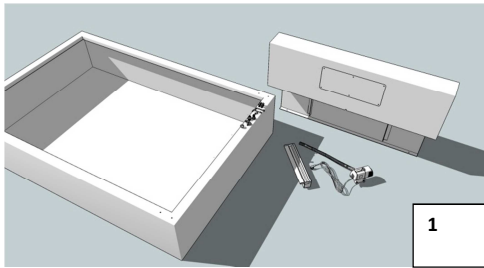

Waterfall 1500, wall ON pond

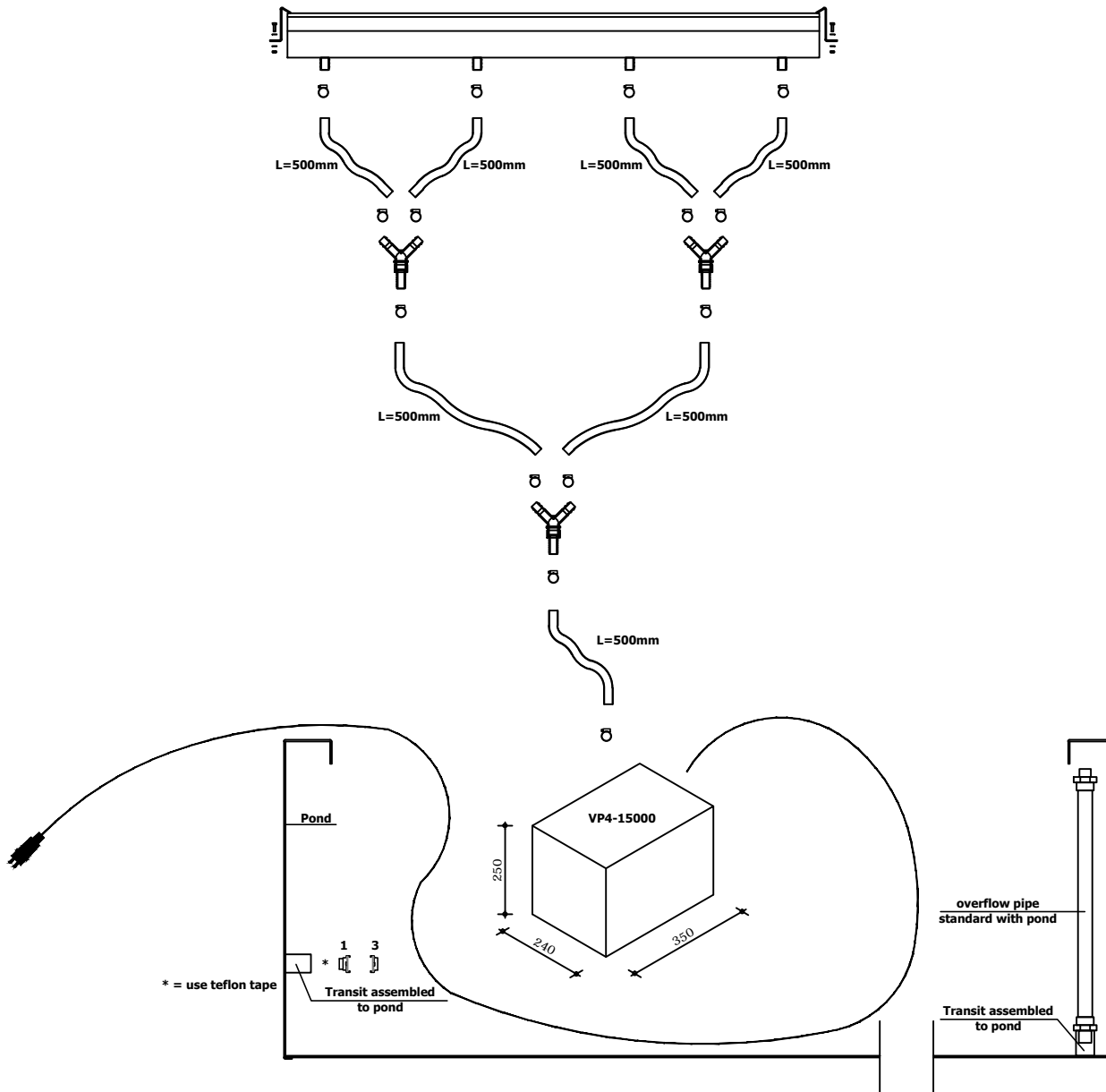

Number	Description	Code
1	Waterfall 1500-50	VB3
1	Waterfall 1500-150	VB4
1	Pump 15000	VP4
2	Hook for fixation (Z-profile)	-
2	Bolt M6-20	-
2	Nut M6	-
4	M6-ring	-
14	Hose clamps	-
3	Y-pieces	-
1	Hose 7x 0,5m	-

Waterfall 600, wall ON pond

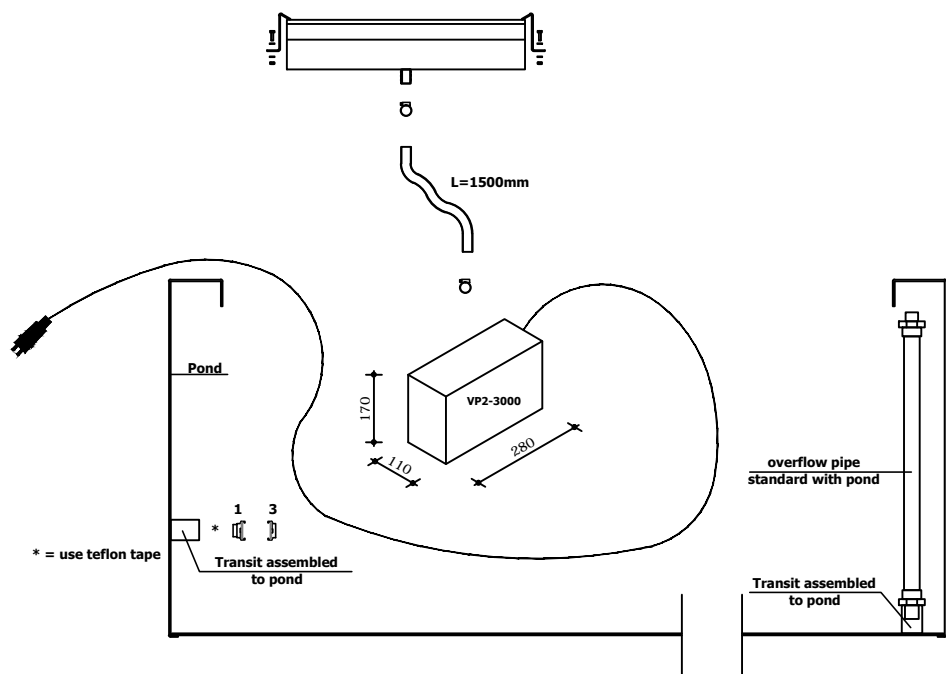

Number	Description	Code
1	Waterfall 600-50	VB1
1	Waterfall 600-150	VB2
1	Pump 3000	VP2
2	Hook for fixation (Z-profile)	-
2	Bolt M6-20	-
2	Nut M6	-
4	M6-ring	-
2	Hose clamps	-
1	Hose 1,5m	-

3 tubes waterfall, wall ON pond

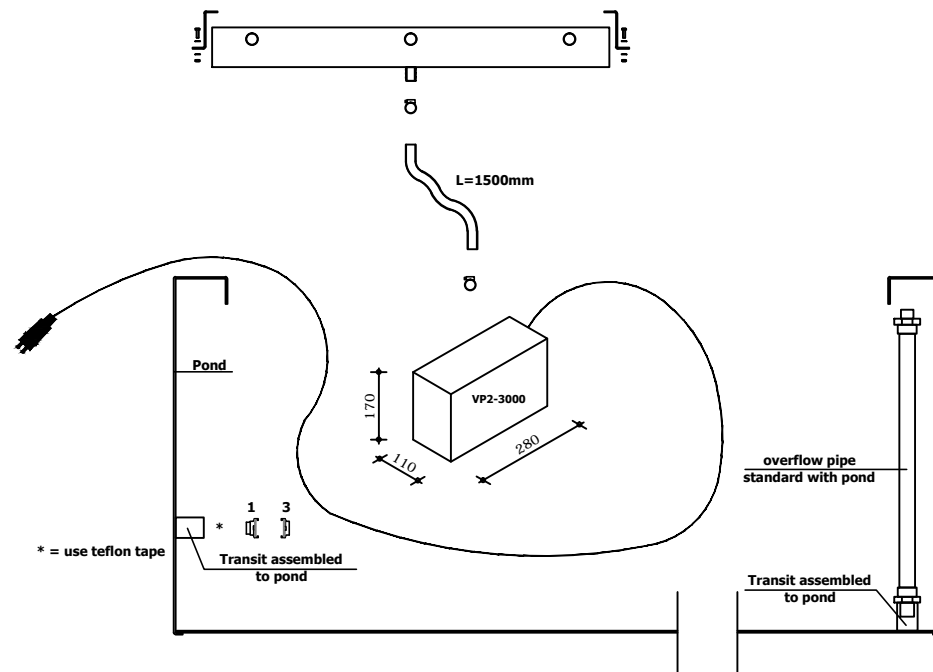

Number	Description	Code
1	Waterfall 3 tubes	VB5
1	Pump 3000	VP2
2	Hook for fixation (Z-profile)	-
2	Bolt M6-20	-
2	Nut M6	-
4	M6-ring	-
2	Hose clamps	-
1	Hose 1,5m	-